



MEETING FACILITIES







SUCCESS IS IN THE DETAILS

Enter a private haven where spectacular views aren't limited to those outside the guest room windows. You'll find nothing but sophistication and elegance here, where carefully selected color schemes, reflective glass and grand chandeliers evoke moments of awe that are hardly fleeting.

With a 3,237 square foot ballroom suite that can be subdivided with ease, several board rooms and breakout spaces, as well as supremely comfortable and elegantly appointed guest rooms, The Helmsley Park Lane Hotel will inspire groups of up to 350 to explore their creativity like never before.





MAIN BALLROOM



MAIN BALLROOM

The Banquet Room is located on the 2nd floor, accessible through a private elevator, with adjoining Lounge and Check Room. This one large, elegant space is capable of being subdivided with sliding walls into two, three or four smaller areas.

BALLROOM EAST	BALLROOM WEST	BALLROOM FULL
48 x 39 1,872 sq. ft	35 x 39 1,365 sq. ft	3,237 sq. ft
14.6 x 11.9 m 173.9 sq. m	10.7 x 11.9 m 126.8 sq. m	300.7 sq. m

Dotted lines indicate where room may be subdivided

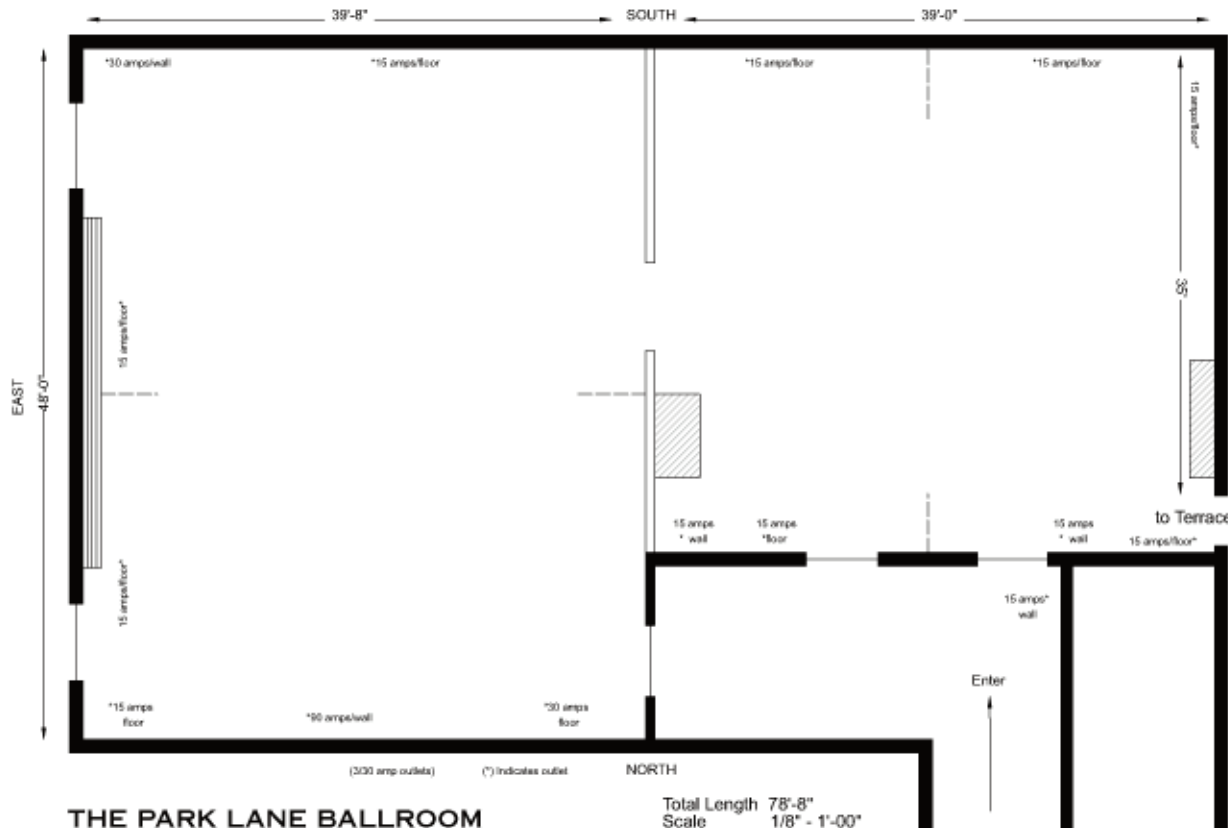

CEILING HEIGHT: 13 ft. to 15 ft., 4 m to 4.6 m

SEATING CAPACITY

Reception & Dinner with Dancing:	N/A	N/A	170
Reception & Dinner without Dancing:	N/A	N/A	200
Dinner without Reception or Dancing:	N/A	N/A	230
Cocktail Reception:	200	150	350
Meeting – Classroom style:	120	60	170
Meeting – Theatre style:	150	100	220
Crescent:	95	70	140
"U":	45	35	
Oval Table:	45	35	

Outdoor terrace is available, weather permitting.

Delivery Entrance – 33 West 58th Street

**Capacities on meeting can increase.
Please call for further details.*

**FOR SALES ASSISTANCE,
CONTACT US AT 212.371.4000**



THE BLACK CHERRY ROOM

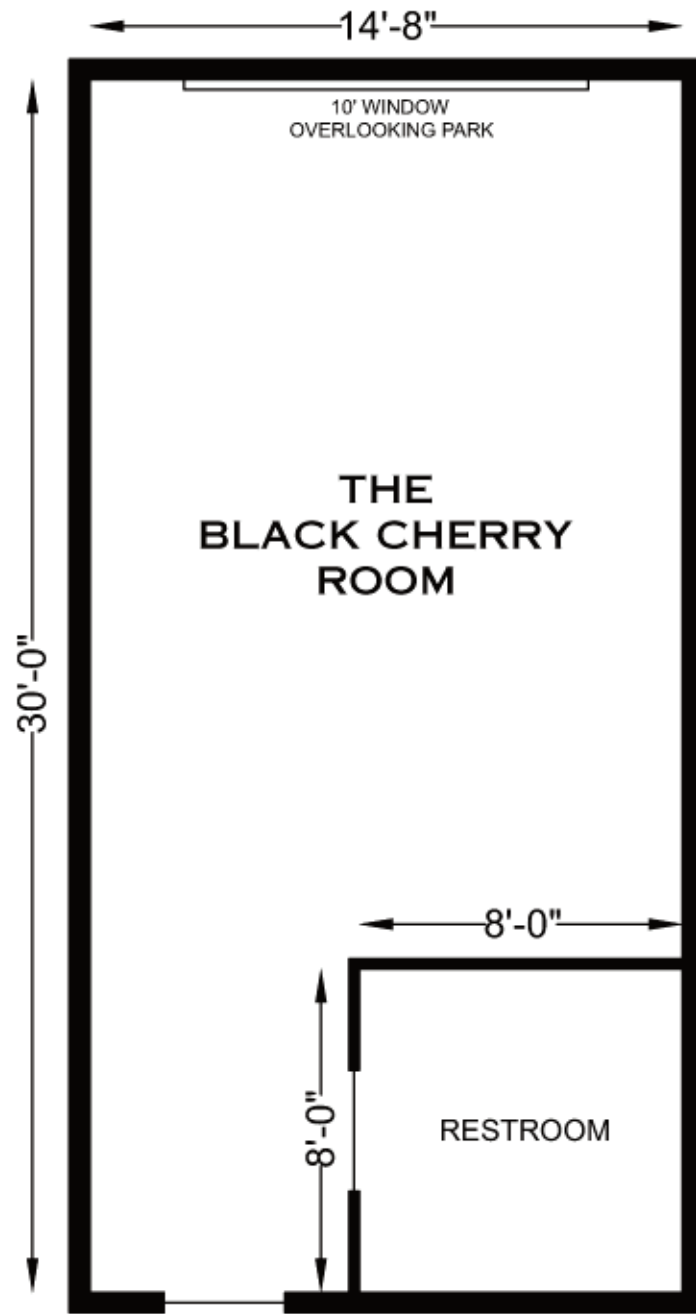

SUITE 500



**THE
BLACK CHERRY
ROOM**

This comfortable north facing room features a cherry wood conference table that can be set for an executive meeting or private dining function. A private restroom, wireless access for your A/V needs and a view of Central Park complete the space.

AREA: 345 square feet
(32.1 sq m)

SEATING CAPACITY

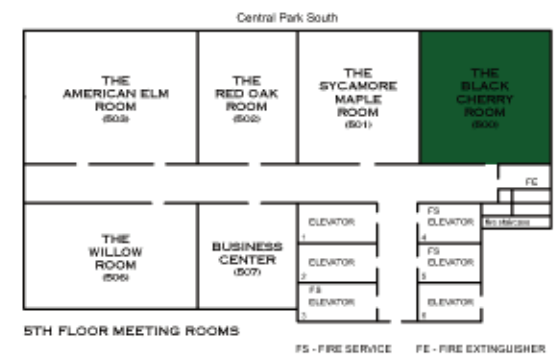
Conference Set-up: 10



5TH FLOOR MEETING ROOMS

FS - FIRE SERVICE FE - FIRE EXTINGUISHER

**FOR SALES ASSISTANCE,
CONTACT US AT 212.371.4000**



THE SYCAMORE MAPLE ROOM

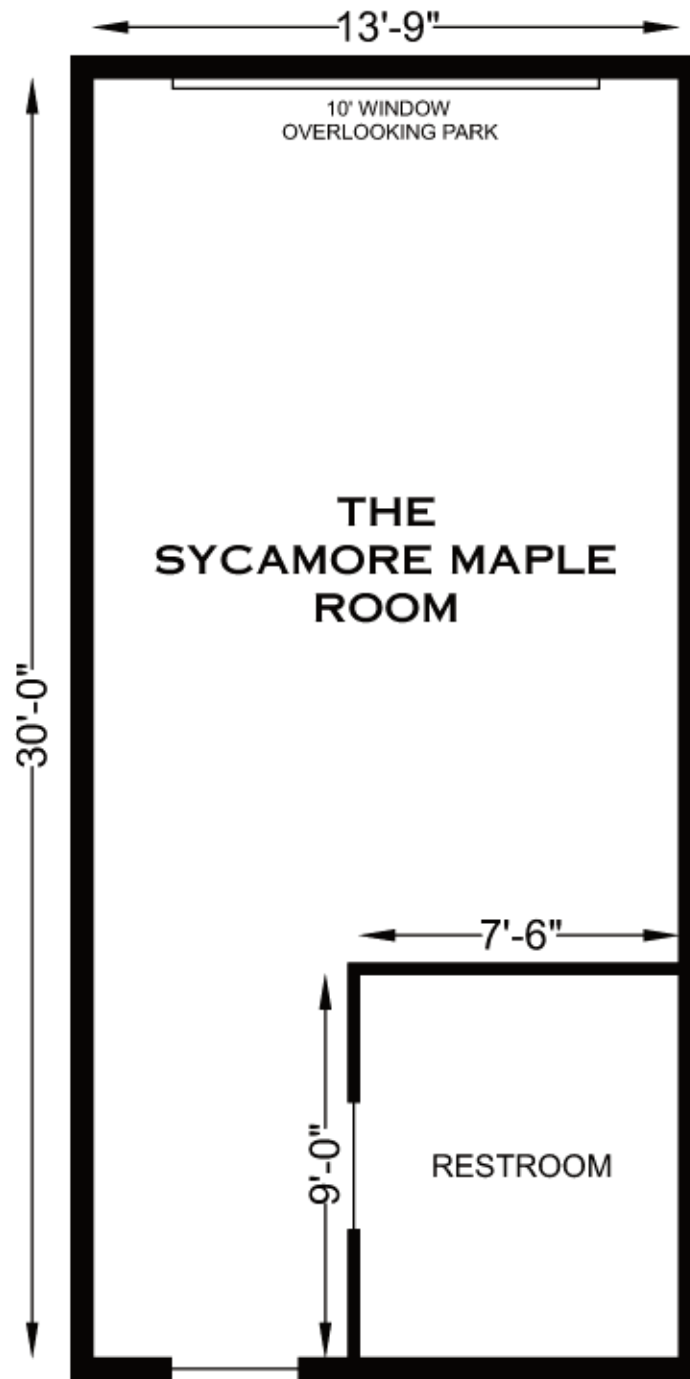

SUITE 501



THE SYCAMORE MAPLE ROOM

This executive meeting room enjoys abundant natural light throughout the day and features a comfortable conference table and upholstered dining-style chairs. The room can be set for meeting or dining functions and offers wireless access and a private restroom.

AREA: 322 square feet
 (29.9 sq m)

SEATING CAPACITY

Conference Set-up: 10

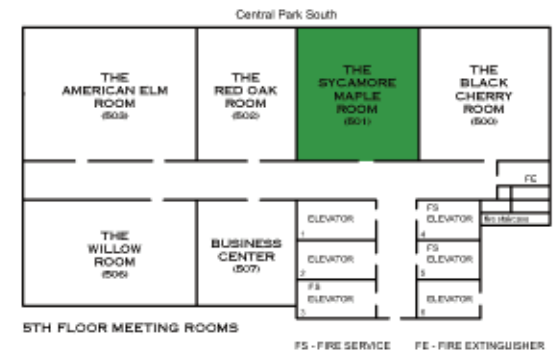

**FOR SALES ASSISTANCE,
 CONTACT US AT 212.371.4000**



THE RED OAK ROOM

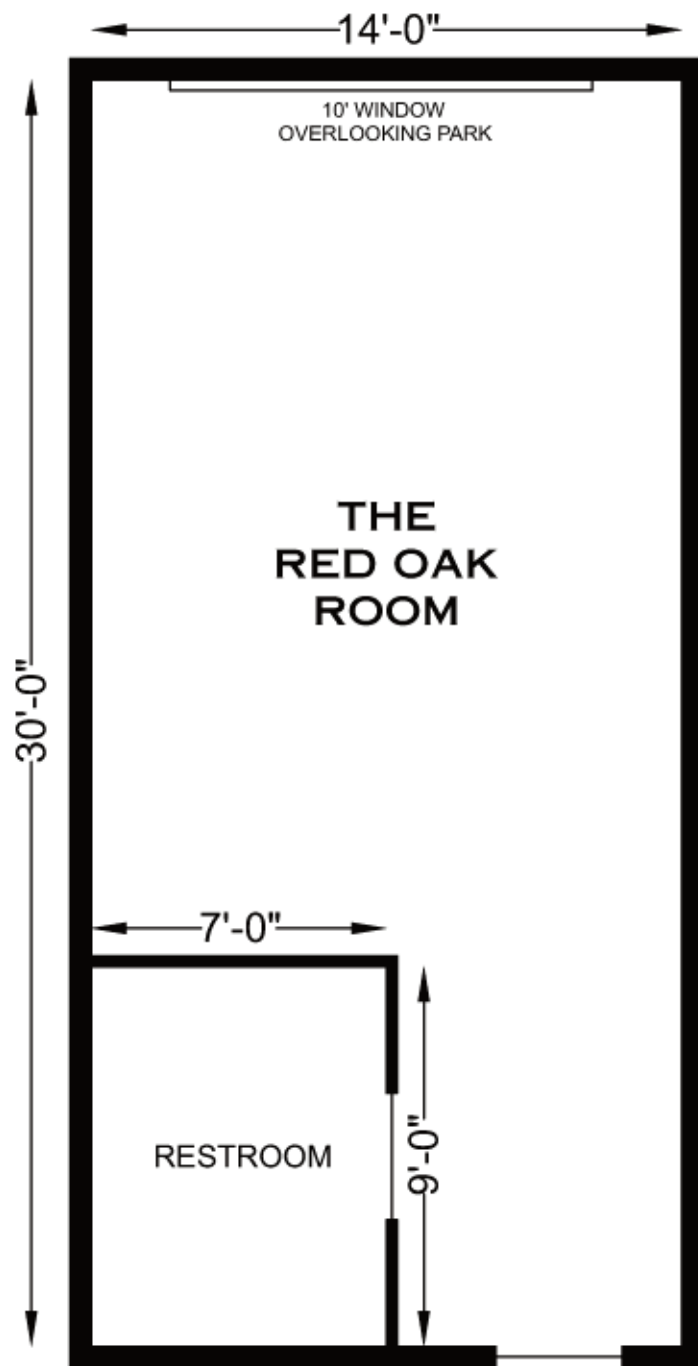

SUITE 502



THE
RED OAK
ROOM

This intimate executive space is set with a round conference table that accommodates six comfortably with ample space in the room to get up and stretch during a meeting or to accommodate coffee service or a buffet table. The room is wireless and offers private restroom facilities.

AREA: 322 square feet
(29.9 sq m)

SEATING CAPACITY

Conference Set-up: 6

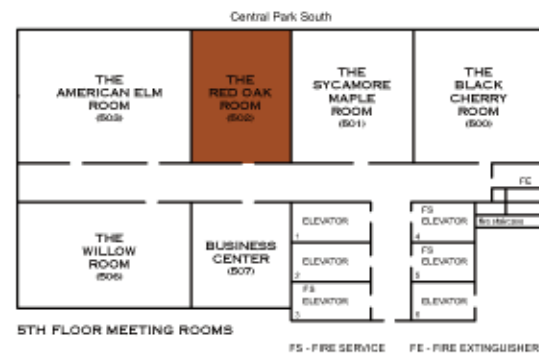

FOR SALES ASSISTANCE,
CONTACT US AT 212.371.4000



THE AMERICAN ELM ROOM



THE AMERICAN ELM ROOM

This spacious meeting room features two large north facing windows offering panoramic views of the Park. The room is wireless, can accommodate any A/V requirements and has private restroom facilities.

AREA: 690 square feet
(64.1 sq m)

SEATING CAPACITY

Conference Set-up:	24
Theater Set-up:	50
Classroom Set-up:	30
U-shaped Set-up:	24
Hollow Square:	24
Banquet:	40

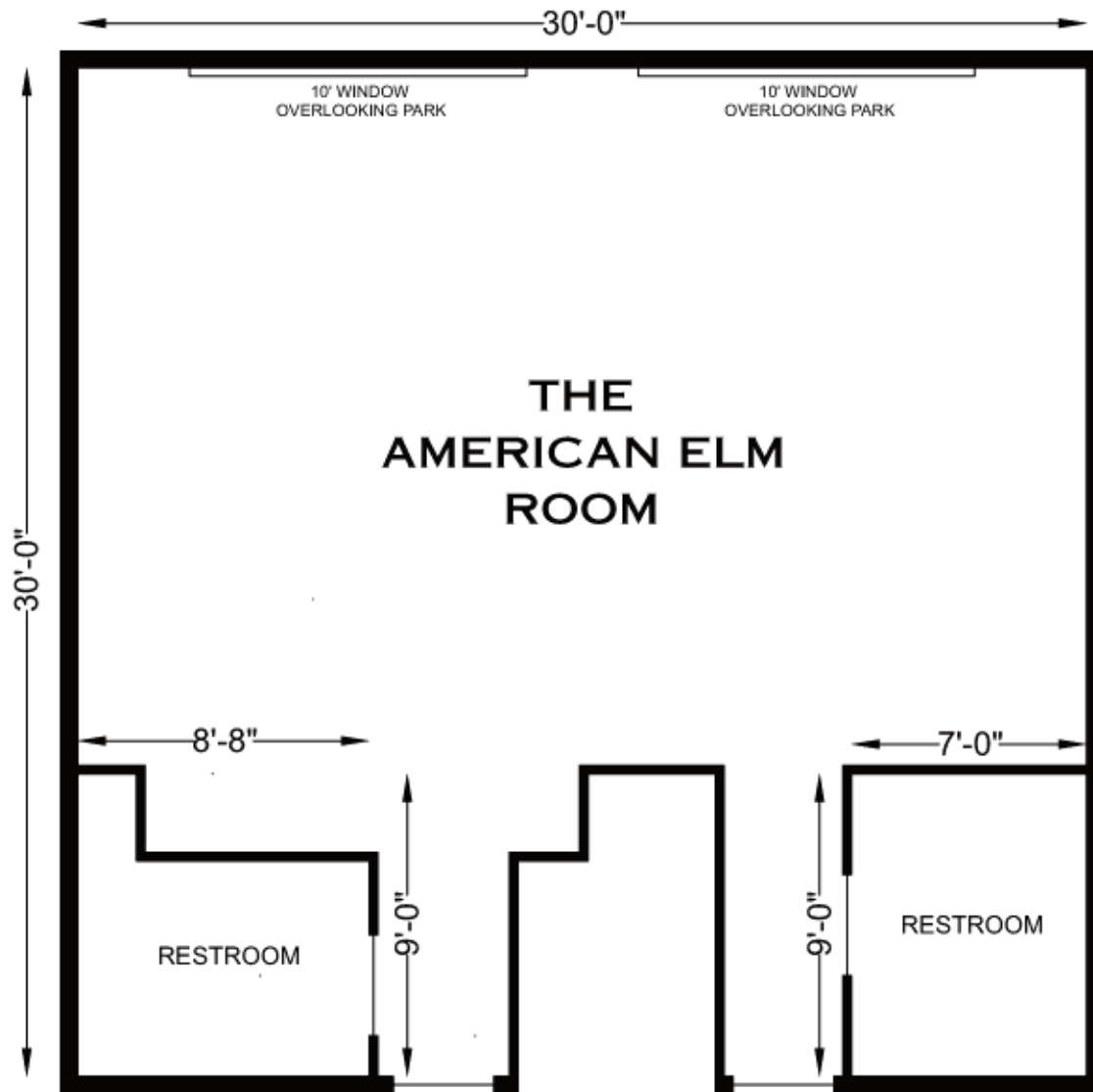

SUITE 503

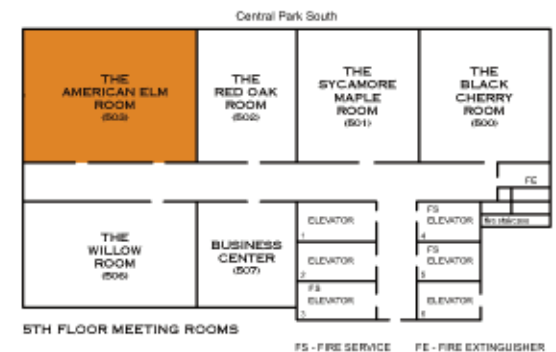

**FOR SALES ASSISTANCE,
CONTACT US AT 212.371.4000**



THE WILLOW ROOM

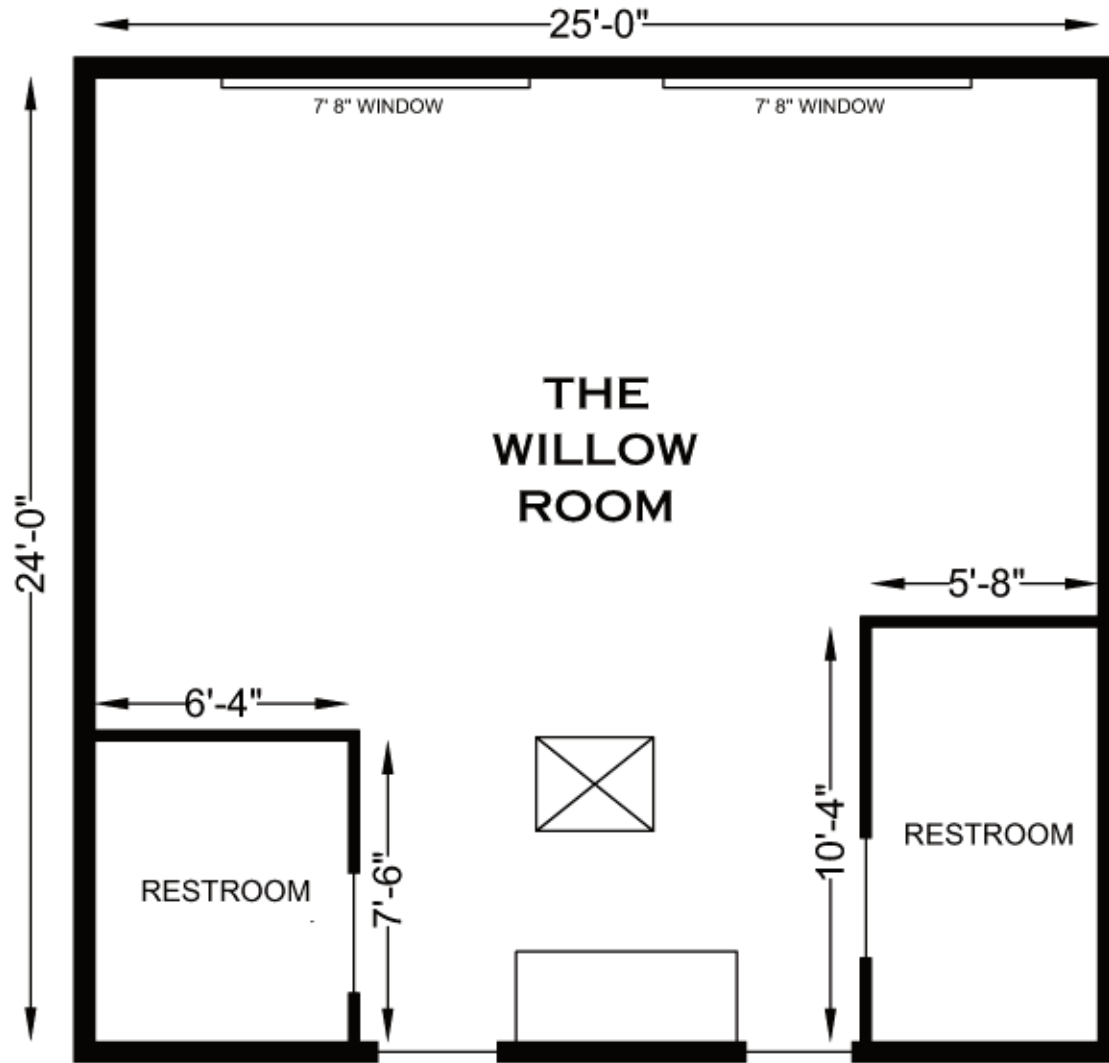

THE WILLOW ROOM

THE WILLOW ROOM

This mid-size meeting space is brightly lit by two large south-facing windows. The room is wireless, can accommodate any A/V requirements and has private restroom facilities.

AREA: 425 square feet
(39.5 sq m)

SEATING CAPACITY

Conference Set-up:	15
Theater Set-up:	30
Classroom Set-up:	24
Banquet:	30

SUITE 506

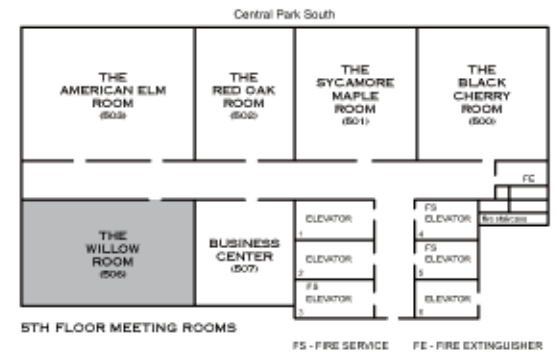

5TH FLOOR MEETING ROOMS

FS - FIRE SERVICE FE - FIRE EXTINGUISHER

FOR SALES ASSISTANCE,
CONTACT US AT 212.371.4000

THE
HELMSLEY

*Park Lane
Hotel*®

NEW YORK

36 CENTRAL PARK SOUTH, NEW YORK, NY 10019

P: 212.371.4000 F: 212.750.7279 | TOLL FREE RESERVATIONS: 800.221.4982

WWW.HELM斯LEYPARKLANE.COM

©2011 HELMSLEY ENTERPRISES INC.

A Member of



SUMMIT

HOTELS & RESORTS™

PREFERRED HOTEL GROUP™